

# INSTRUCTION

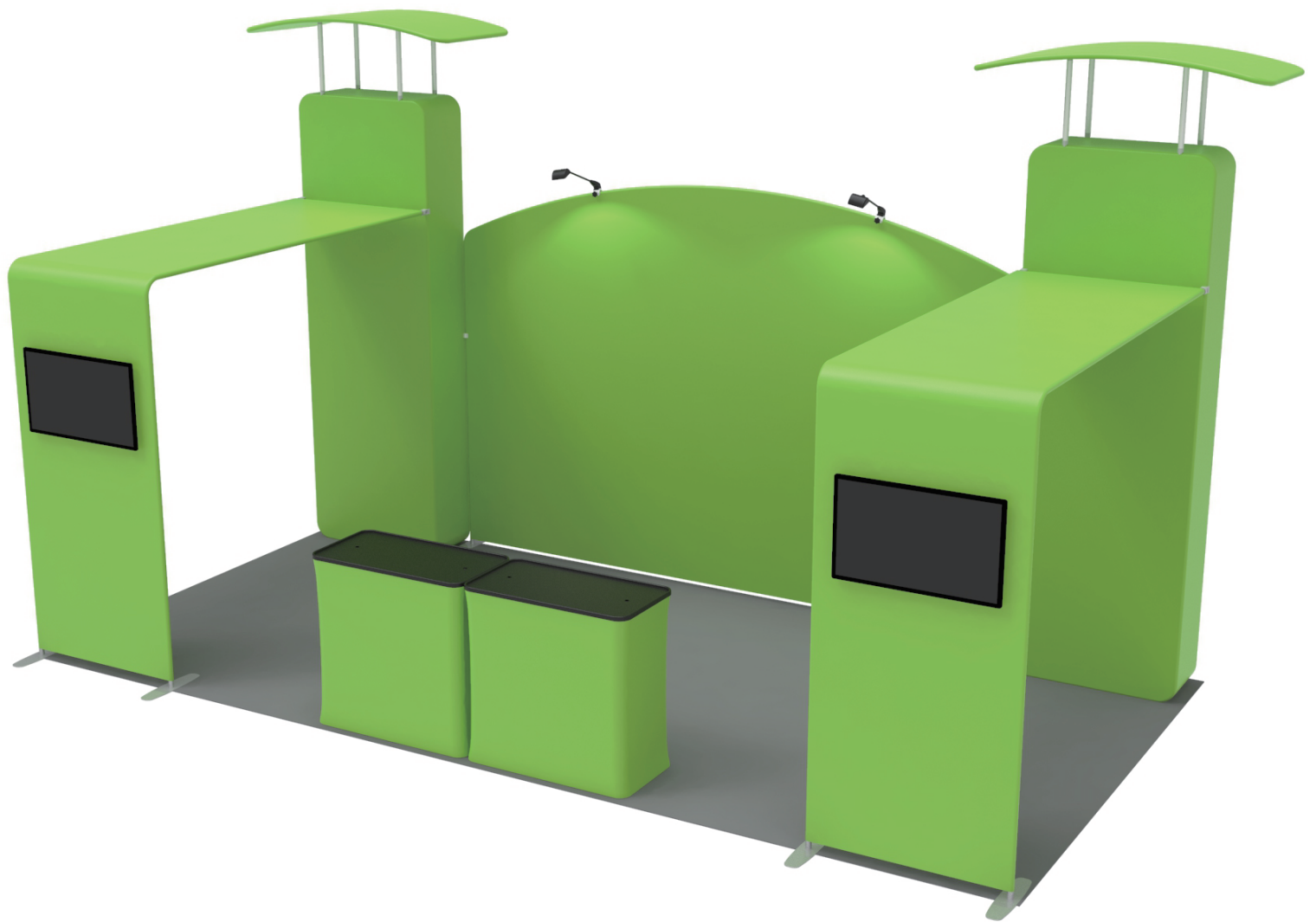

**10X20FT-BOOTH-14**

## STEPS

(1) Hardware

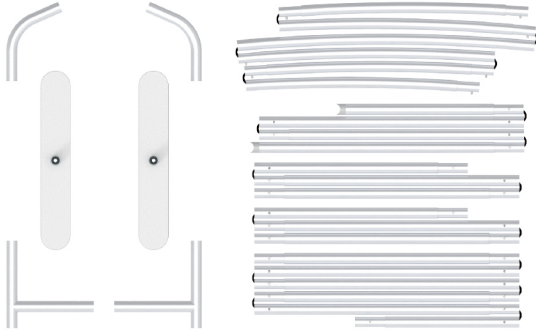

(2) Printed Graphic Fabric Banner (Optional)

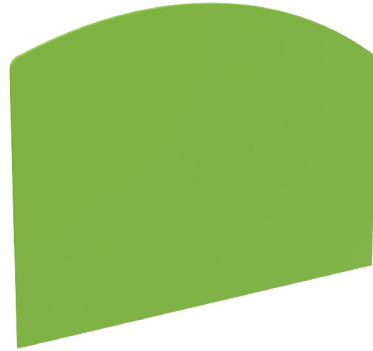

### STEP 01

Connect to make long poles according to labelings.

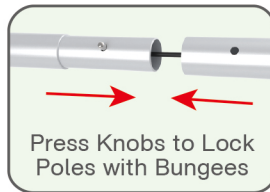

### STEP 02

Connect long poles with corner poles according to labelings, connect support pole onto frame.

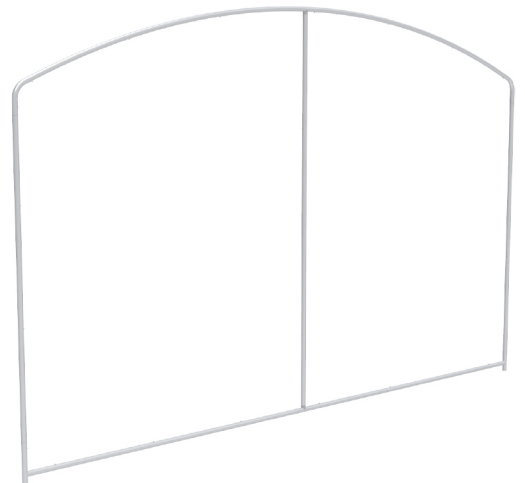
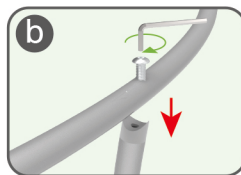
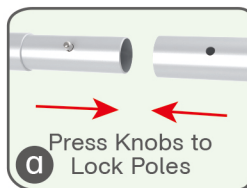
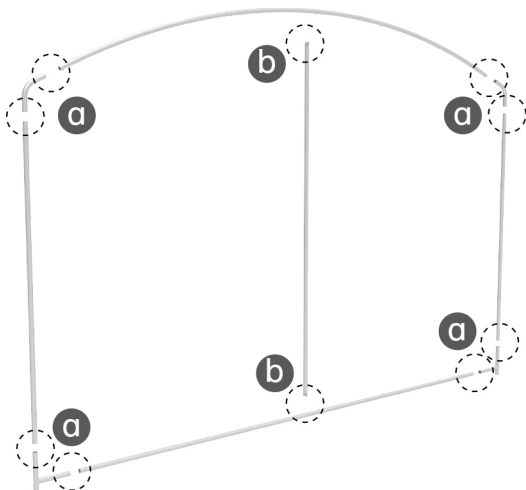

## STEPS

### STEP 03

Slide fabric banner on frame from top and zip up at bottom.

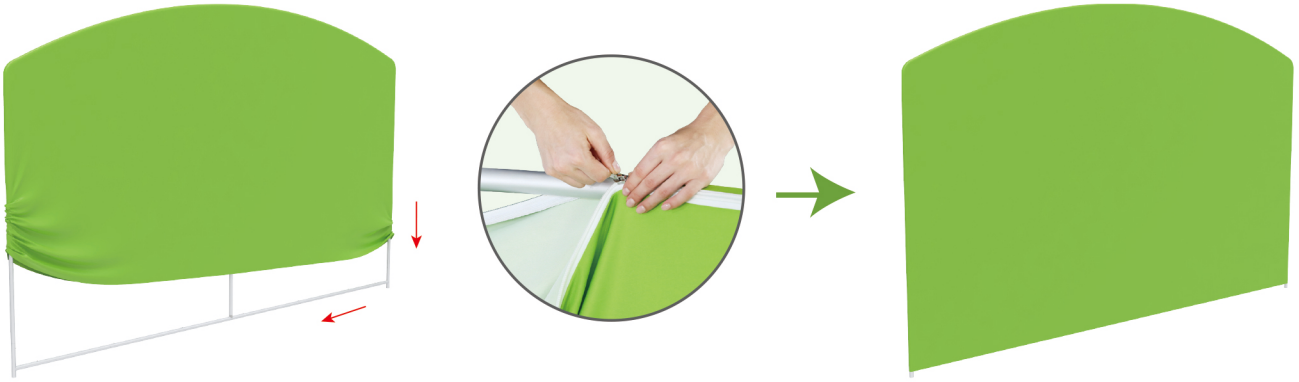

### STEP 04

Insert display stand onto feet by pressing their knobs.

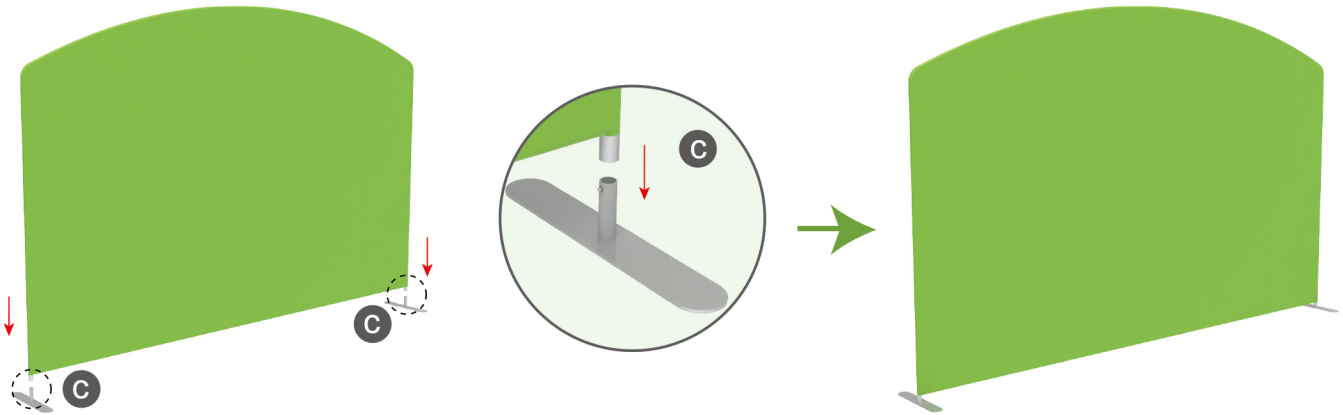

(1) Hardware

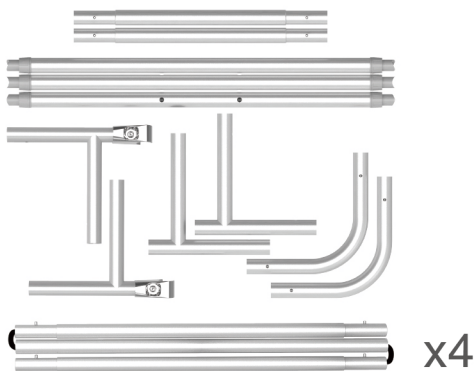

(2) Printed Graphic Fabric Banner (Optional)



## STEPS

**STEP 01** Connect to make long poles according to labelings.

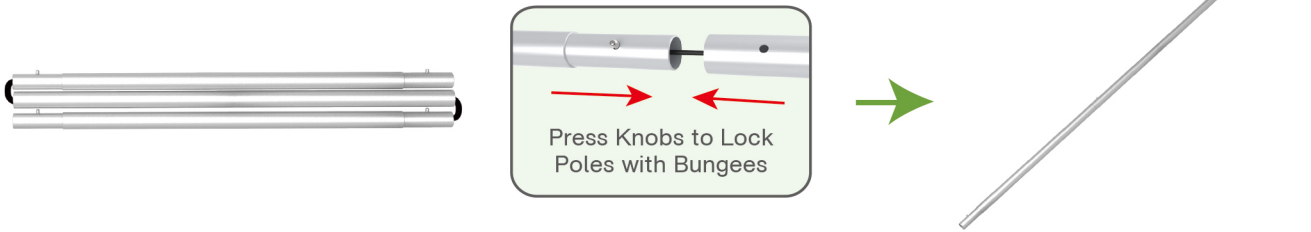

**STEP 02** Connect long poles with corner poles according to labelings.

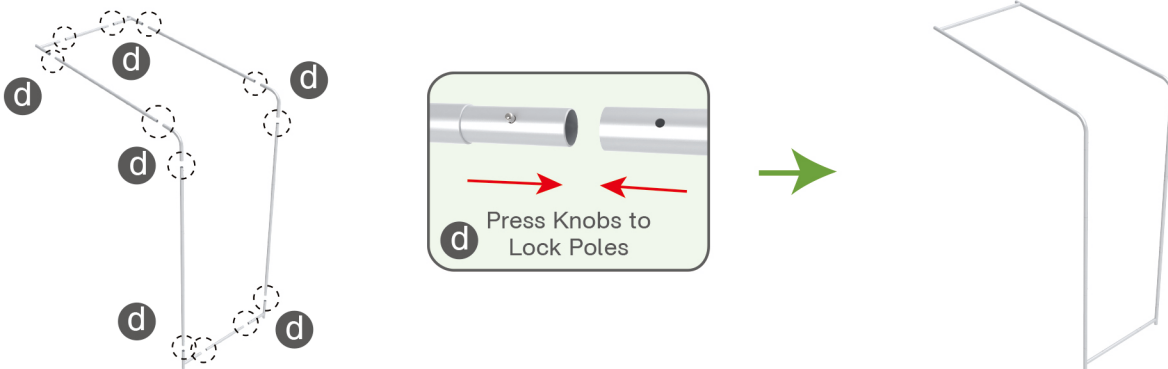

**STEP 03** Connect support poles onto frame.

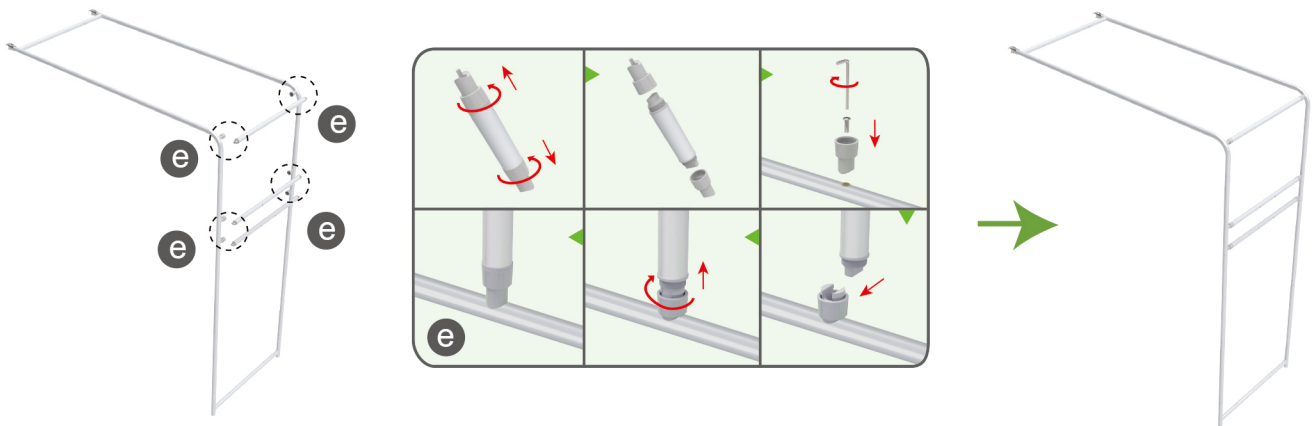

**STEP 04** Slide fabric banner on frame from top and zip up at bottom.

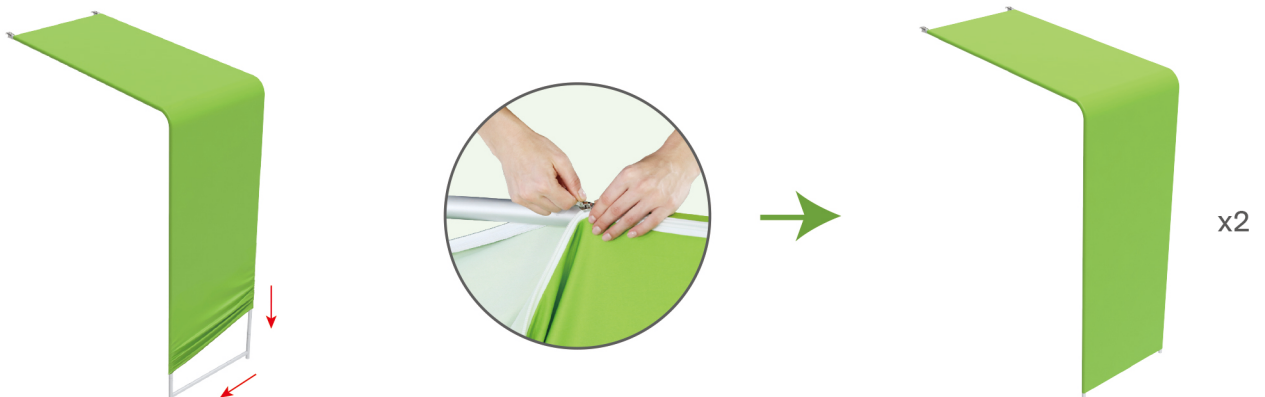

## STEPS

(1) Hardware



(2) Printed Graphic Fabric Banner (Optional)



### STEP 01

Connect to make long poles according to labelings.

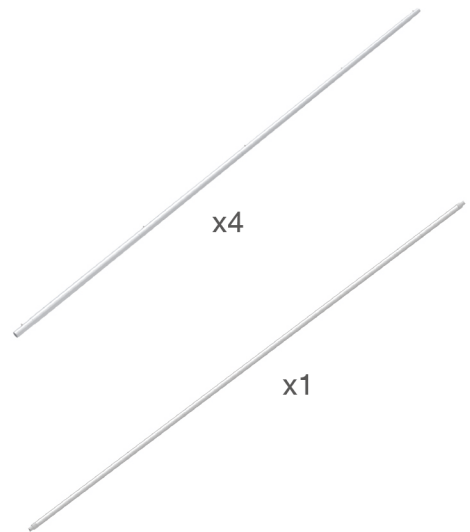
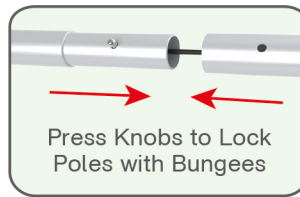

### STEP 02

Connect long poles with corner poles according to labelings.

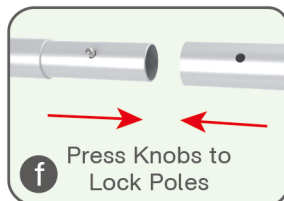
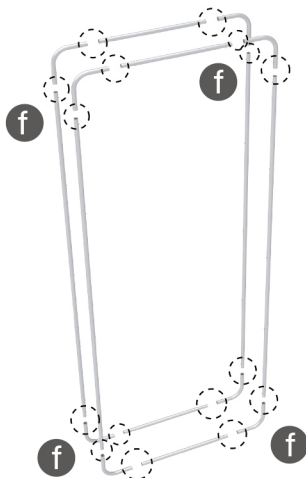

## STEPS

### STEP 03

Connect support poles onto column frame.

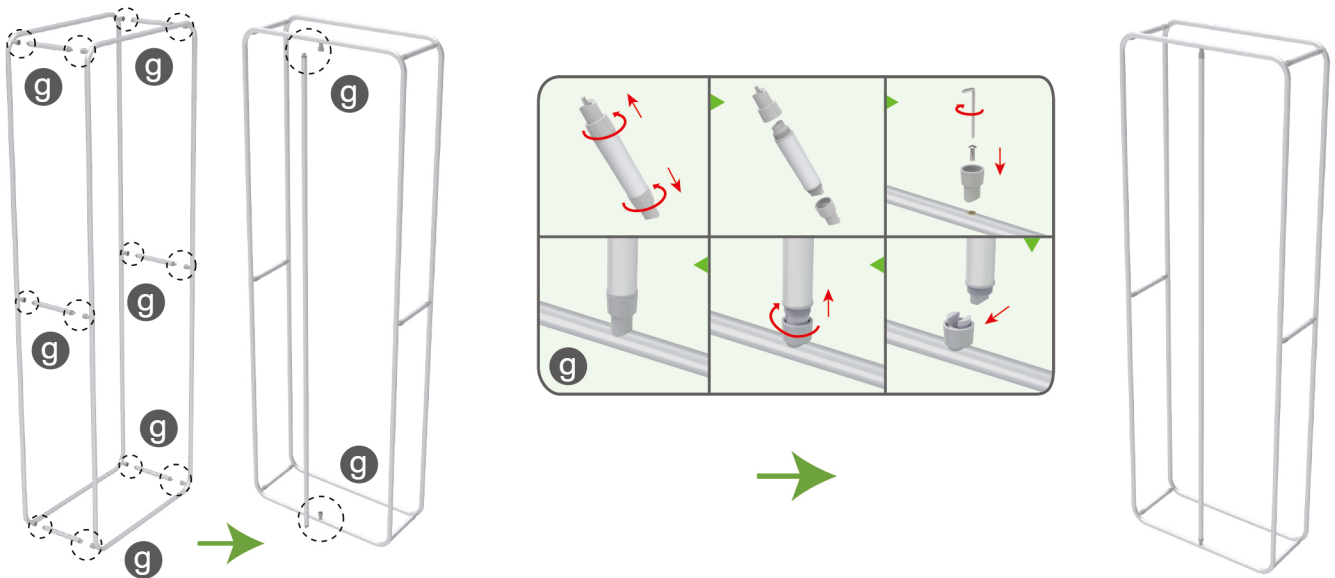

### STEP 04

Slide fabric banner on frame from top and zip up at bottom.

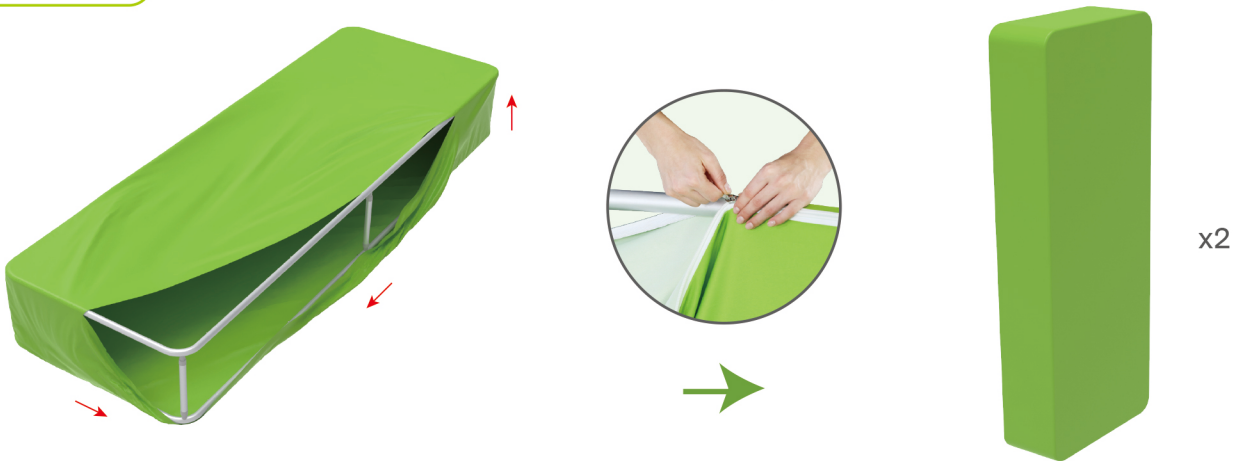

#### (1) Hardware

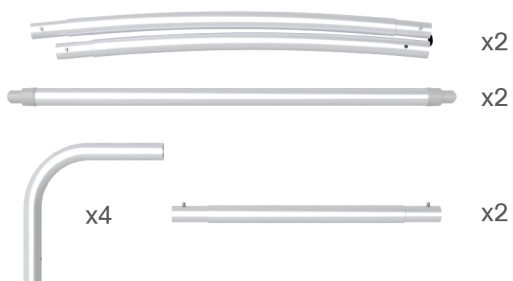

#### (2) Printed Graphic Fabric Banner (Optional)



## STEPS

**STEP 01** Connect to make long poles according to labelings.

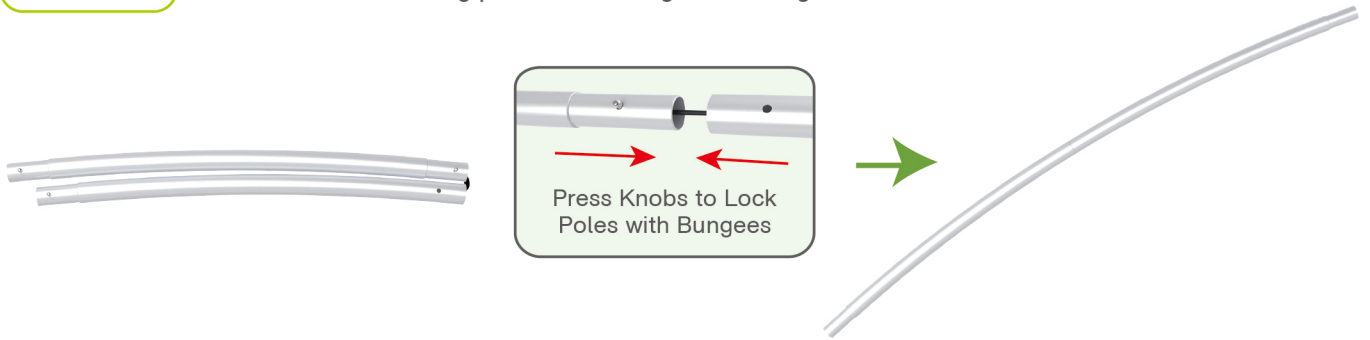

**STEP 02** Connect long poles with corner poles according to labelings.

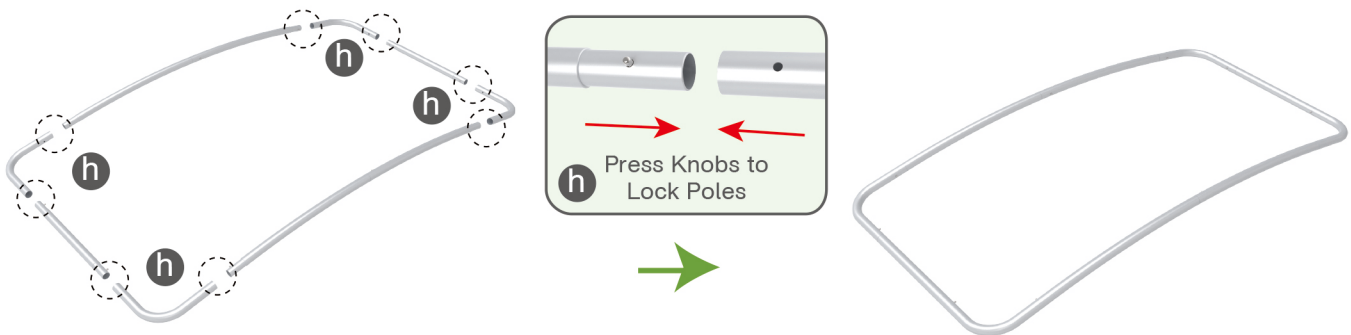

**STEP 03** Connect support poles onto frame.

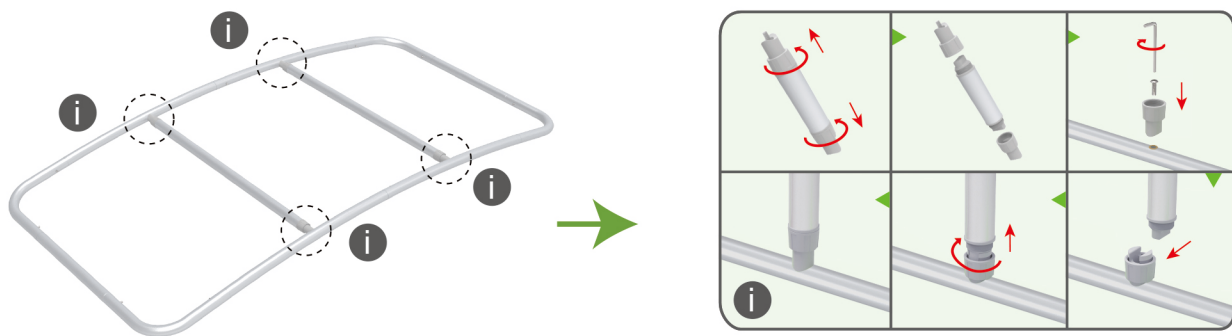

**STEP 04** Slide fabric banner on frame from left and zip up at right.

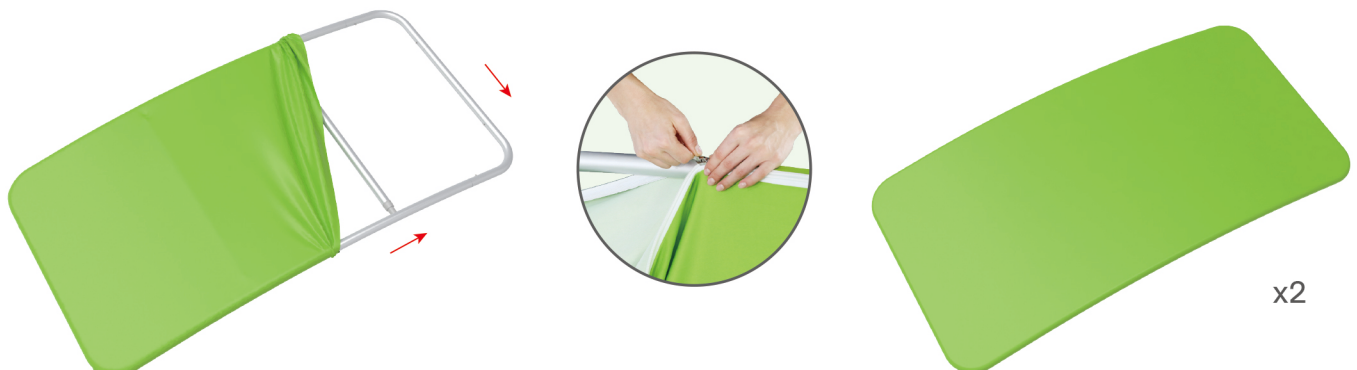

## STEPS

### Booth Set Assembly

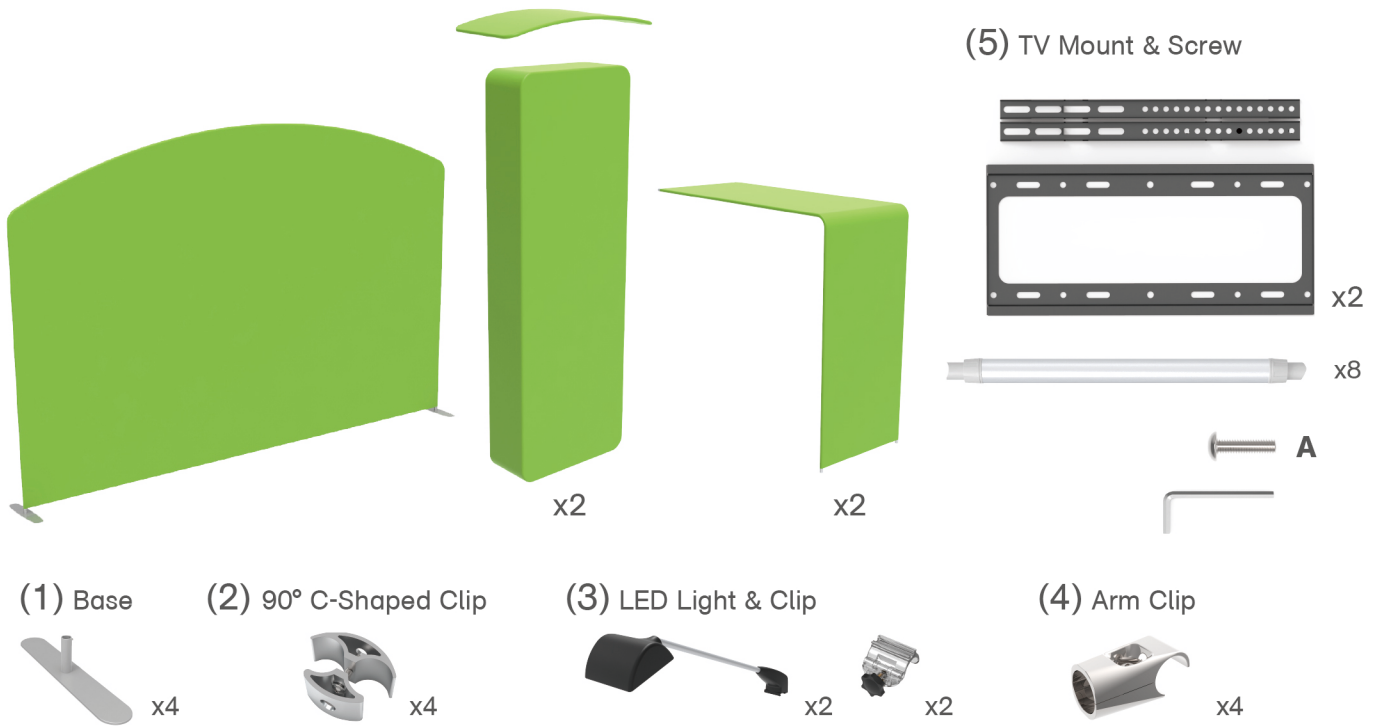

#### STEP 01

Connect support poles onto column frame and canopy.

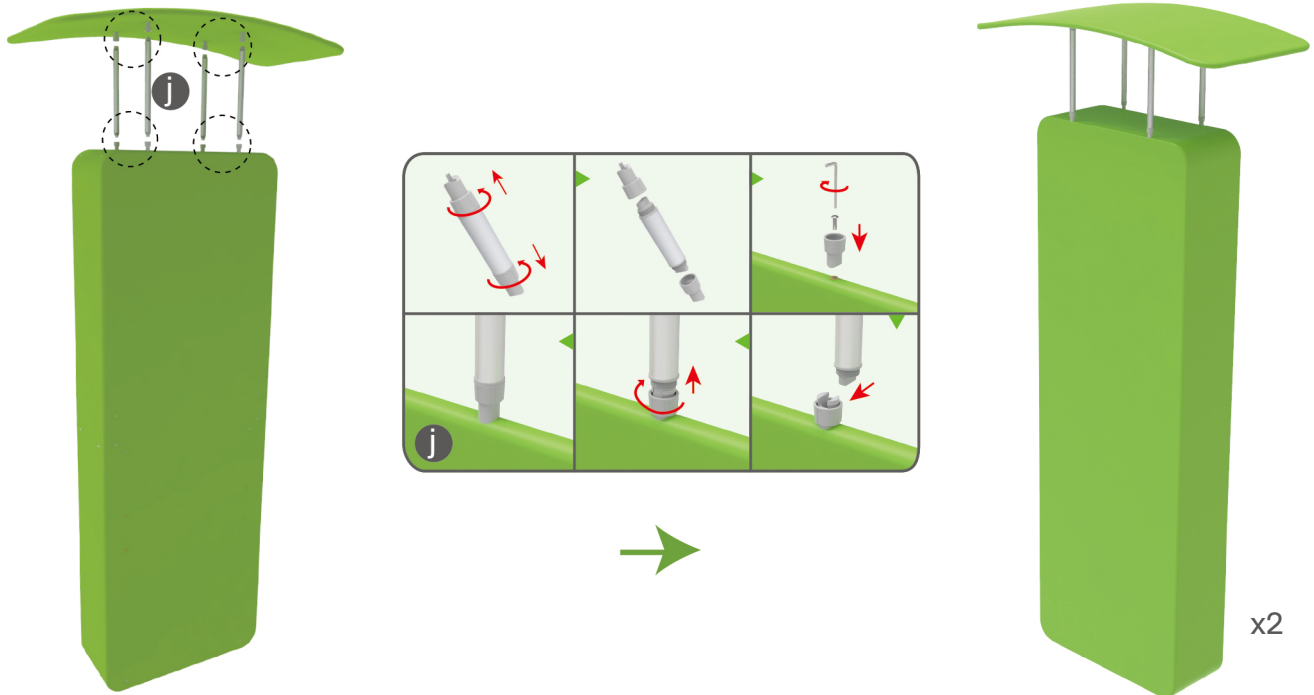



## STEPS

### STEP 02

Interconnect display stands with C-shaped clips.

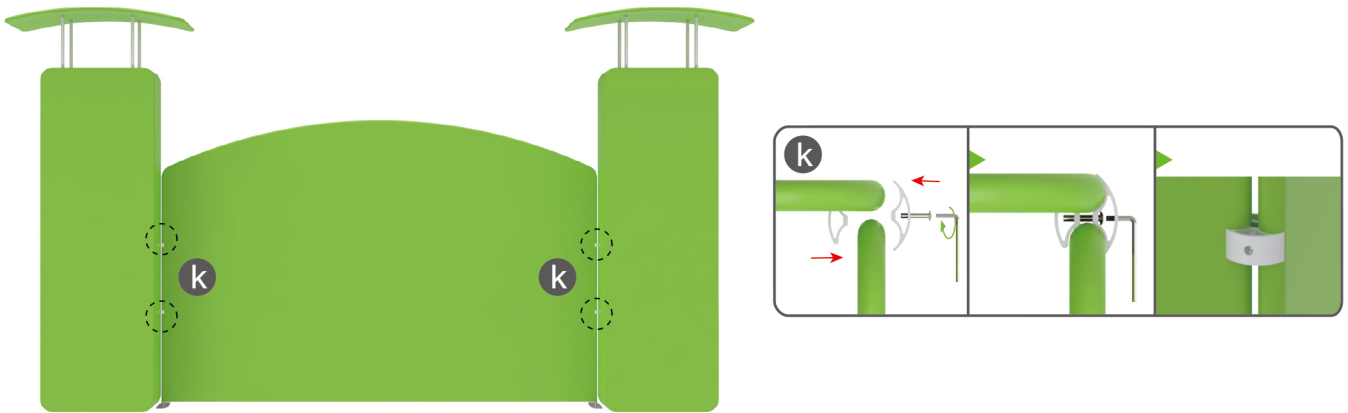

### STEP 03

Connect display stands with arm clips and Insert display stands onto feet by pressing their knobs.

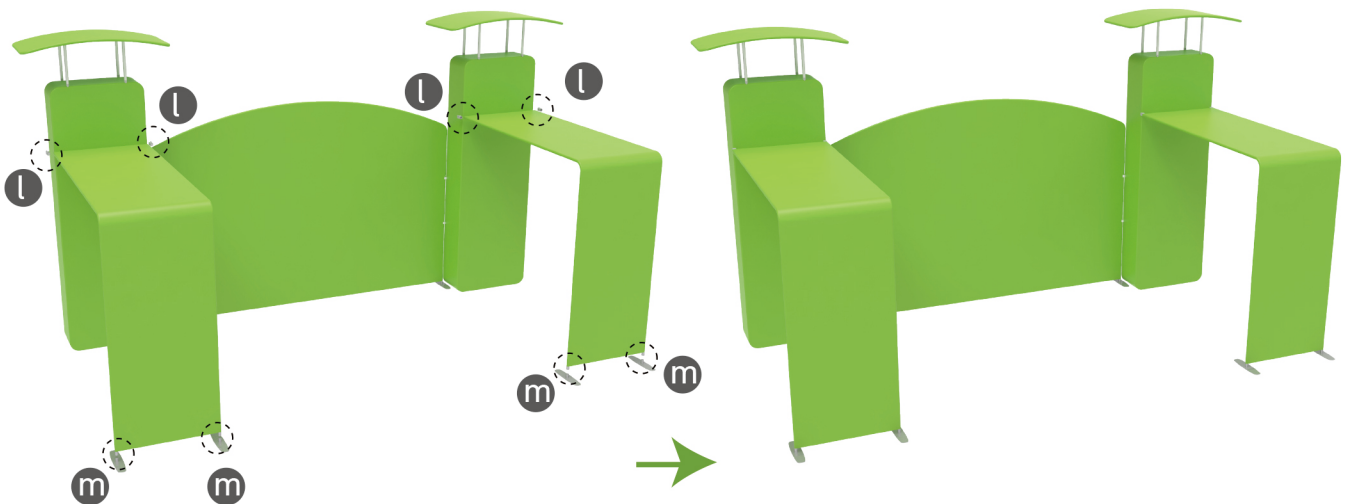

## STEPS

**STEP 04** Screw TV mount with hex wrench.

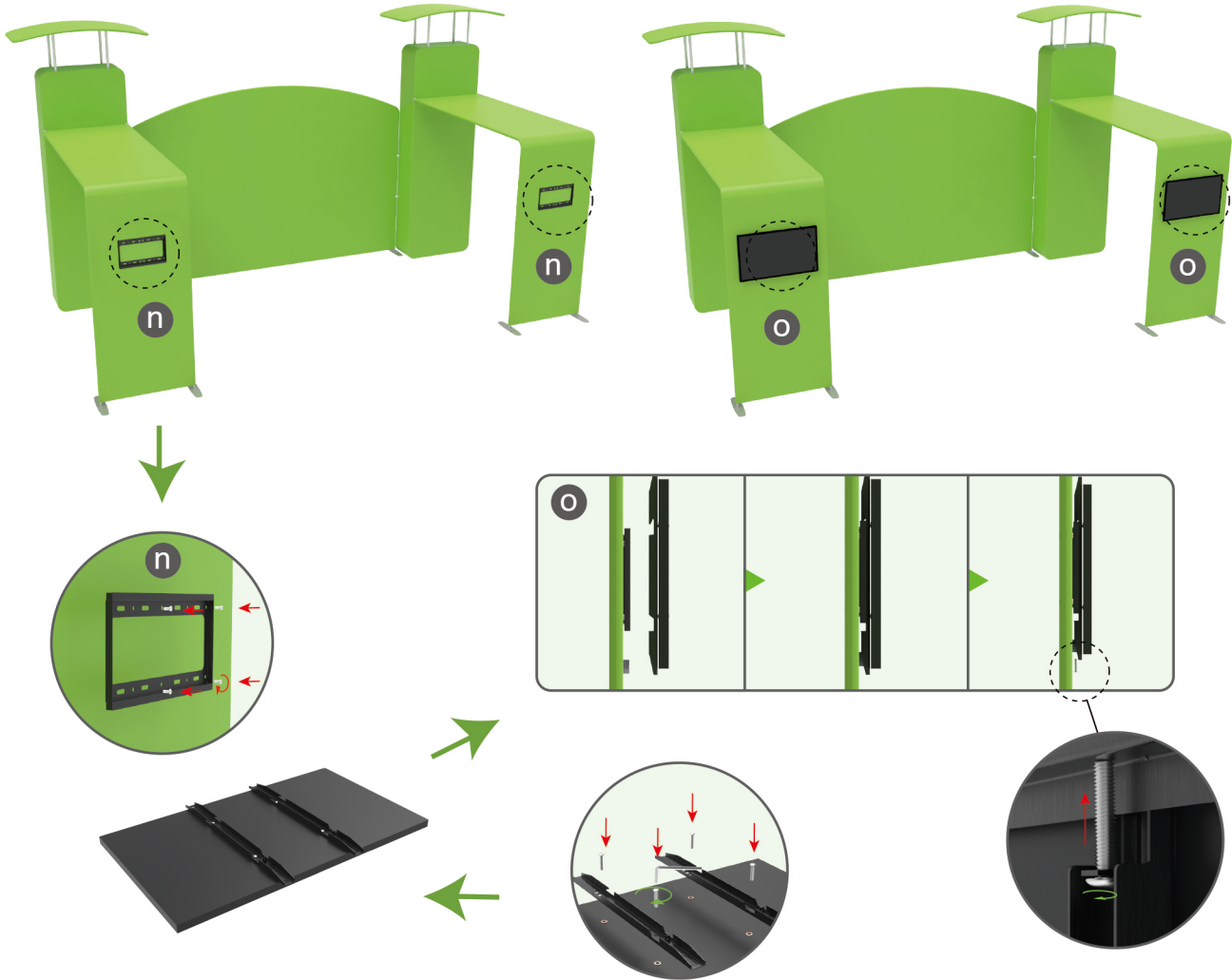

**STEP 05** Screw light clips at top of display stands, slide lights onto them and adjust their direction.

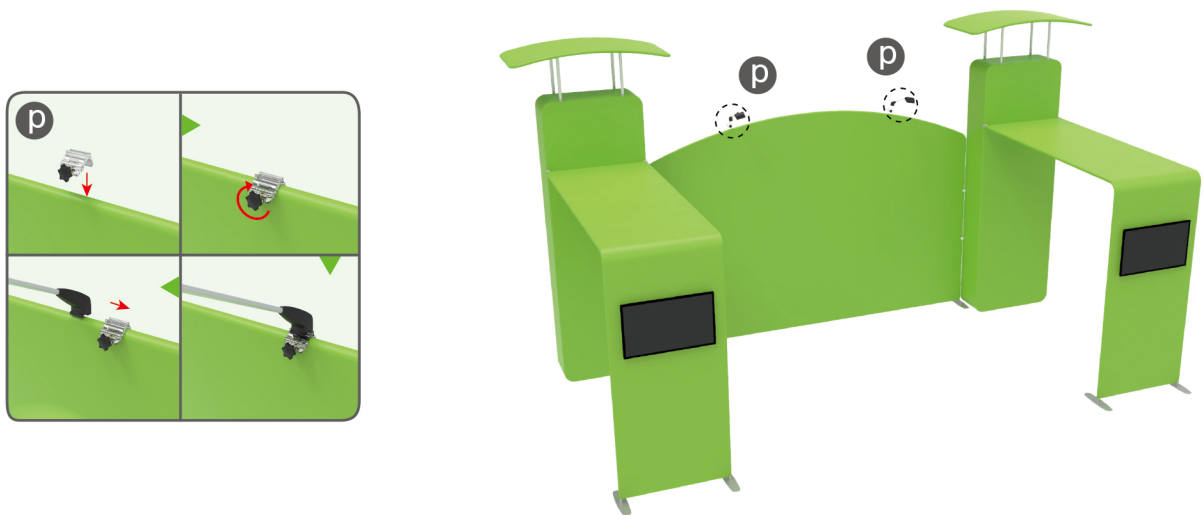

**STEPS**

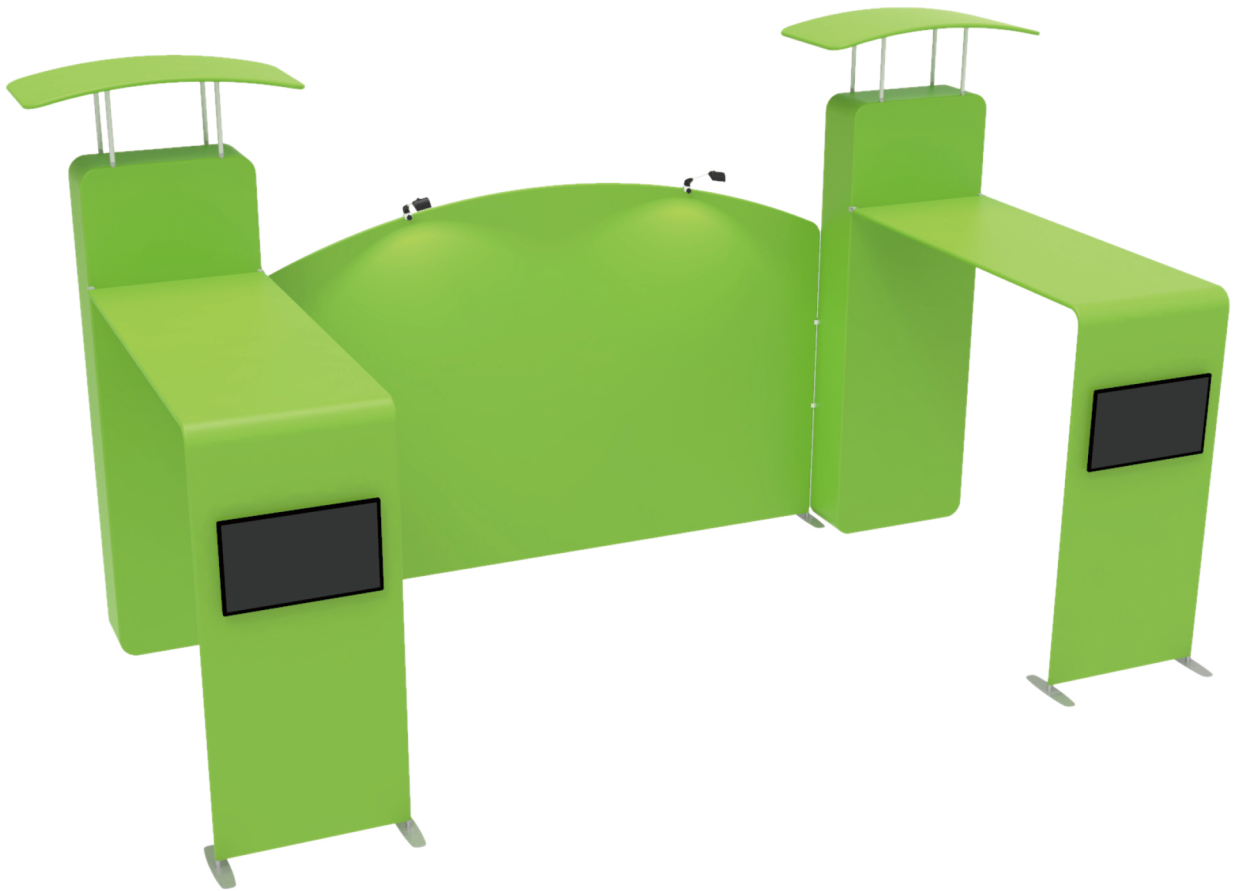

**10X20FT-BOOTH-14**

## STEPS

(1) Durable Plastic Hard Case, Aluminum Support Poles



(2) Printed Graphic Fabric Banner



### STEP 01

Put hard case's top into fabric banner.

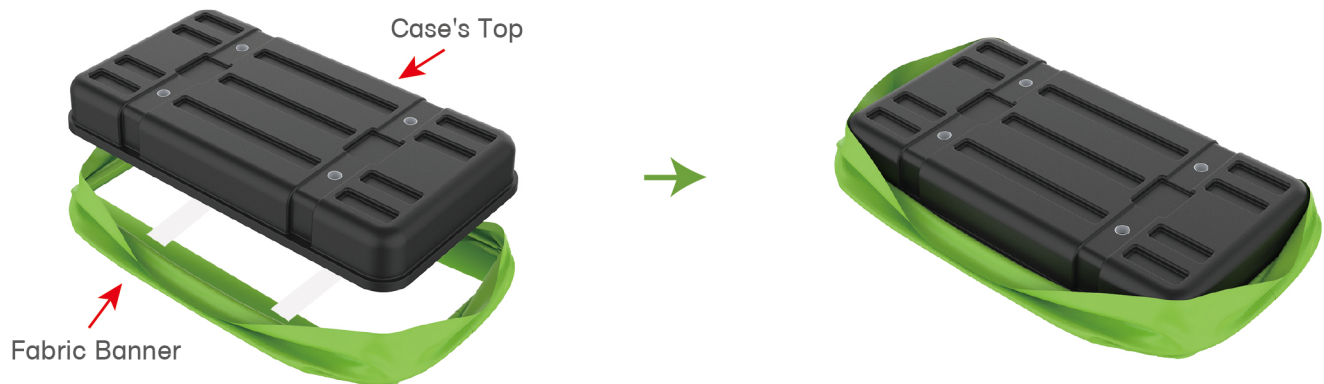

### STEP 02

Insert support poles into hard case's top & bottom.

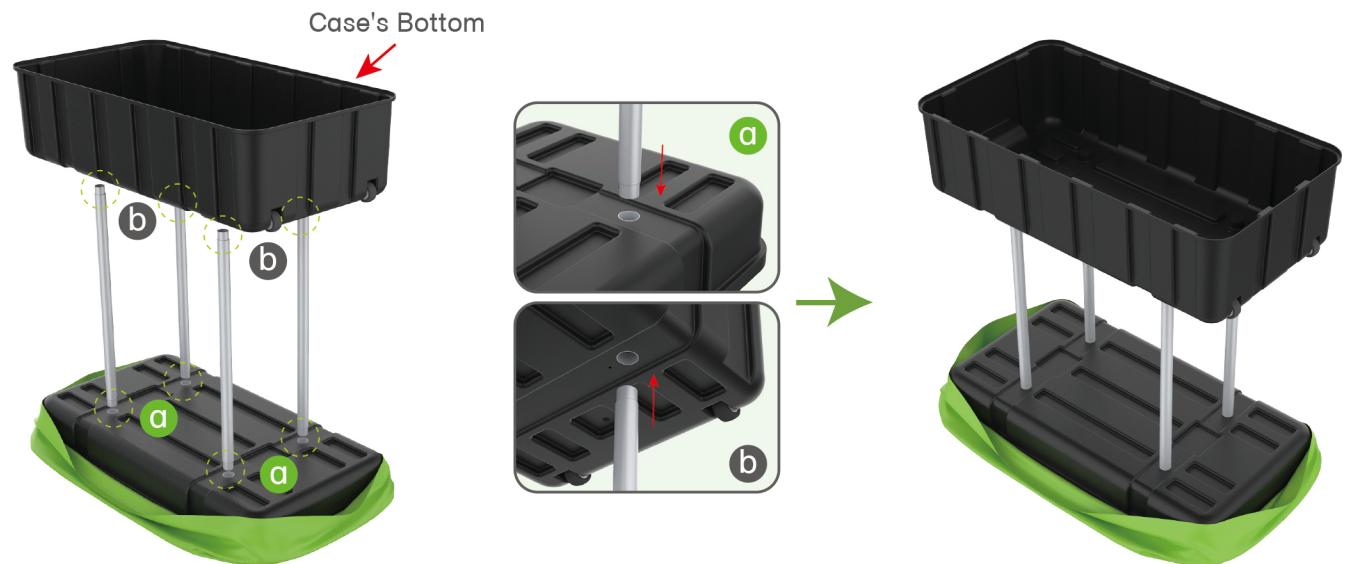

### STEPS

#### STEP 04

Wrap fabric banner from bottom to top & twist it to be smooth, lay hard case's intermediate panel on podium's top.

